



**TRANSPORTATION CABINET**

Frankfort, Kentucky 40622  
www.transportation.ky.gov/

**Steven L. Beshear**  
Governor

**Michael W. Hancock, P.E.**  
Secretary

May 14, 2012

CALL NO. 402  
CONTRACT ID NO. 121321  
ADDENDUM # 1

Subject: Muhlenberg County, 089GR12D004-JL03  
Letting May 18, 2012

- (1) Revised - Plan Sheets - R1, R2B, & R20A
- (2) Revised - Front Sheet of Proposal
- (3) Revised - Material Summary - Pages 87-90 of 148
- (4) Revised - Bid Items - Pages 141-148 of 148

Proposal revisions are available at <http://transportation.ky.gov/Construction-Procurement/>.

Plan revisions are available at <http://www.lynnimaging.com/kytransportation/>.

If you have any questions, please contact us at 502-564-3500.

Sincerely,

A handwritten signature in blue ink that reads "Ryan Griffith".

Ryan Griffith  
Director  
Division of Construction Procurement

RG:ks  
Enclosures



An Equal Opportunity Employer M/F/D

COUNTY OF	ITEM NO.	SHEET NO.
MUHLENBERG	2-138.10	RI

△ REVISED 5-14-12



# Commonwealth of Kentucky DEPARTMENT OF HIGHWAYS

## PLANS OF PROPOSED PROJECT US 62 - KY 181 INTERSECTION GRADE, DRAIN & SURFACING PLANS JL03 089 0062 010-011

INDEX OF SHEETS	
SHEET NO.	DESCRIPTION
R1	LAYOUT SHEET
R2-R2D	TYPICAL SECTIONS-SUMMARY OF QUANTITIES
R2E	GENERAL NOTES
R3-R10	PLAN AND PROFILE SHEETS
R11	UTILITY REFERENCE SHEETS
R12	RIGHT OF WAY SUMMARY SHEETS
R13	RIGHT OF WAY STRIP MAP SHEETS
R14-R20a	DETAIL SHEETS
R21-R24	TRAFFIC CONTROL SHEETS
R25-R28	EROSION CONTROL SHEETS
R29	COORDINATE CONTROL SHEETS
R30-R36	PIPE DRAINAGE SHEETS
X1-X30	CROSS SECTION SHEETS
U1 - U22	Utility Relocation Plans
T1-T10	Traffic Plans

SHEETS NOT INCLUDED IN TOTAL SHEETS  
R2A-R2E

STANDARD DRAWINGS		
NUMBER		
RDB-012-09	RDI-020-08	RGX-005-05
RDB-013-06	RDI-021	RGX-010-03
RDB-014-05	RDI-025-04	RGX-020-12
RDB-015-03	RDI-026	RGX-030-06
RDB-016-02	RDM-001-06	RPM-100-09
RDB-017-02	RDM-100-02	RPM-110-05
RDB-018-03	RDX-210-02	RPM-120-06
RDB-019-03	RDX-215	RPM-160-03
RDB-020-04	RDX-220-04	TTD-125
RDB-100-04	RDX-225	
RDB-101-04	RDX-230	
RDB-430-04	RGX-001-05	
RDD-040-04	RGX-002-08	

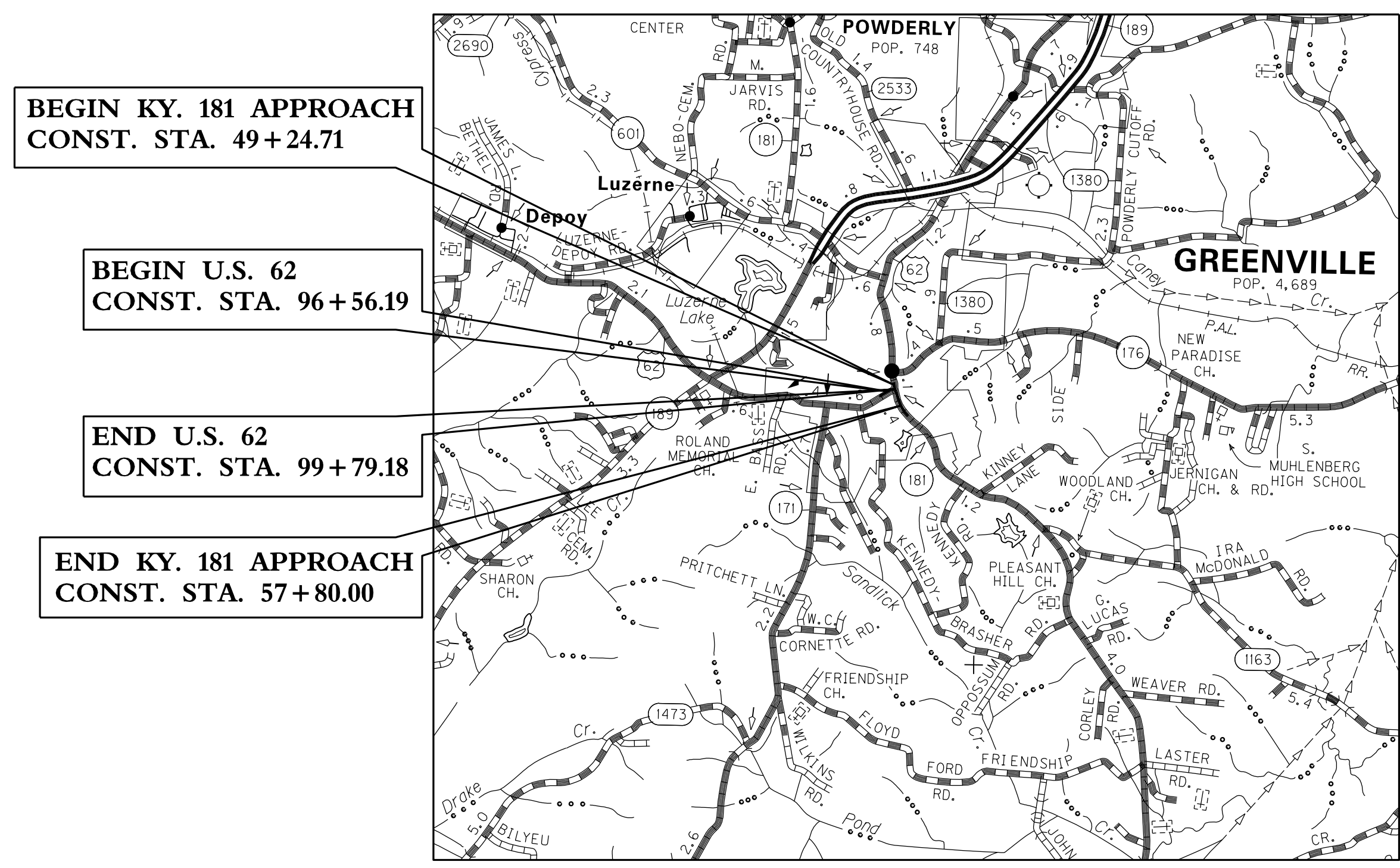

THE CONTROL OF ACCESS ON THIS PROJECT SHALL BE BY PERMIT

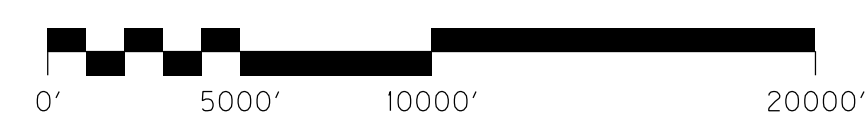

### LAYOUT MAP

FILE NAME: F:\WORK\0501\0501A\DON\0501ACOVER.DGN  
USER: Jim  
DATE PLOTTED: September 12, 2011  
E-SHEET NAME:  
MicroStation v8.11.7.180

### DESIGN CRITERIA

CLASS OF HIGHWAY	URBAN COLLECTOR
TYPE OF TERRAIN	ROLLING
DESIGN SPEED	35 M.P.H.
REQUIRED NPSD	250'
REQUIRED PSD	
LEVEL OF SERVICE	
ADT PRESENT ( 2005 )	8200
ADT FUTURE ( 2026 )	11,100
DHV (2026)	1070
D %	
T %	12.6%

### GEOGRAPHIC COORDINATES

LATITUDE 37 DEGREES 11 MINUTES 56 SECONDS NORTH  
LONGITUDE 87 DEGREES 10 MINUTES 42 SECONDS WEST

### DESIGNED

% RESTRICTED SD	
LEVEL OF SERVICE	
MAX. DISTANCE W/O PASSING	

U.S. 62		KY 181					
LENGTH	<u>322.99</u> LIN. FT. <u>0.061</u> MILES	LENGTH	<u>855.29</u> LIN. FT. <u>0.162</u> MILES	LENGTH	_____ LIN. FT. _____ MILES	LENGTH	_____ LIN. FT. _____ MILES
ADDED	<input type="checkbox"/> FOR EQUALITIES _____ LIN. FT.	ADDED	<input type="checkbox"/> FOR EQUALITIES _____ LIN. FT.	ADDED	<input type="checkbox"/> FOR EQUALITIES _____ LIN. FT.	ADDED	<input type="checkbox"/> FOR EQUALITIES _____ LIN. FT.
DEDUCTED	<input type="checkbox"/> NOT INCLUDED _____ LIN. FT.	DEDUCTED	<input type="checkbox"/> NOT INCLUDED _____ LIN. FT.	DEDUCTED	<input type="checkbox"/> NOT INCLUDED _____ LIN. FT.	DEDUCTED	<input type="checkbox"/> NOT INCLUDED _____ LIN. FT.
RAILROAD CROSSINGS NO.	_____ LIN. FT.	RAILROAD CROSSINGS NO.	_____ LIN. FT.	RAILROAD CROSSINGS NO.	_____ LIN. FT.	RAILROAD CROSSINGS NO.	_____ LIN. FT.
BRIDGES	_____ LIN. FT.	BRIDGES	_____ LIN. FT.	BRIDGES	_____ LIN. FT.	BRIDGES	_____ LIN. FT.

Commonwealth of Kentucky  
DEPARTMENT OF HIGHWAYS  
COUNTY OF  
**MUHLENBERG**

ITEM NO. 2-138.10  
PROJECT NUMBER: JL03 089 0062 010-011  
LETTING DATE: \_\_\_\_\_

RECOMMENDED BY: Charolette Cotton **3-26-12**  
PROJECT MANAGER DATE:  
PLAN APPROVED BY: [Signature] **2-26-12**  
STATE HIGHWAY ENGINEER DATE:

Plans Prepared By :  
MUNICIPAL ENGINEERING COMPANY

*Eric Brad Gregory*  
ERIC BRAD GREGORY, P.E.  
KY. NO. 22833

COUNTY OF	ITEM NO.	SHEET NO.
MUHLENBERG	2-138.10	RI

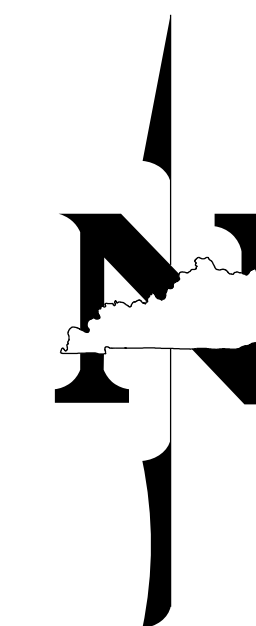

# Commonwealth of Kentucky DEPARTMENT OF HIGHWAYS

## PLANS OF PROPOSED PROJECT US 62 - KY 181 INTERSECTION GRADE, DRAIN & SURFACING PLANS JL03 089 0062 010-011

INDEX OF SHEETS	
SHEET NO.	DESCRIPTION
R1	LAYOUT SHEET
R2-R2D	TYPICAL SECTIONS-SUMMARY OF QUANTITIES
R2E	GENERAL NOTES
R3-R10	PLAN AND PROFILE SHEETS
R11	UTILITY REFERENCE SHEETS
R12	RIGHT OF WAY SUMMARY SHEETS
R13	RIGHT OF WAY STRIP MAP SHEETS
R14-R20a	DETAIL SHEETS
R21-R24	TRAFFIC CONTROL SHEETS
R25-R28	EROSION CONTROL SHEETS
R29	COORDINATE CONTROL SHEETS
R30-R36	PIPE DRAINAGE SHEETS
X1-X30	CROSS SECTION SHEETS
U1 - U22	Utility Relocation Plans
T1-T10	Traffic Plans

SHEETS NOT INCLUDED IN TOTAL SHEETS  
R2A-R2E

STANDARD DRAWINGS		
NUMBER		
RDB-012-09	RDI-020-08	RGX-005-05
RDB-013-06	RDI-021	RGX-010-03
RDB-014-05	RDI-025-04	RGX-020-12
RDB-015-03	RDI-026	RGX-030-06
RDB-016-02	RDM-001-06	RPM-100-09
RDB-017-02	RDM-100-02	RPM-110-05
RDB-018-03	RDX-210-02	RPM-120-06
RDB-019-03	RDX-215	RPM-160-03
RDB-020-04	RDX-220-04	TTD-125
RDB-100-04	RDX-225	
RDB-101-04	RDX-230	
RDB-430-04	RGX-001-05	
RDD-040-04	RGX-002-08	

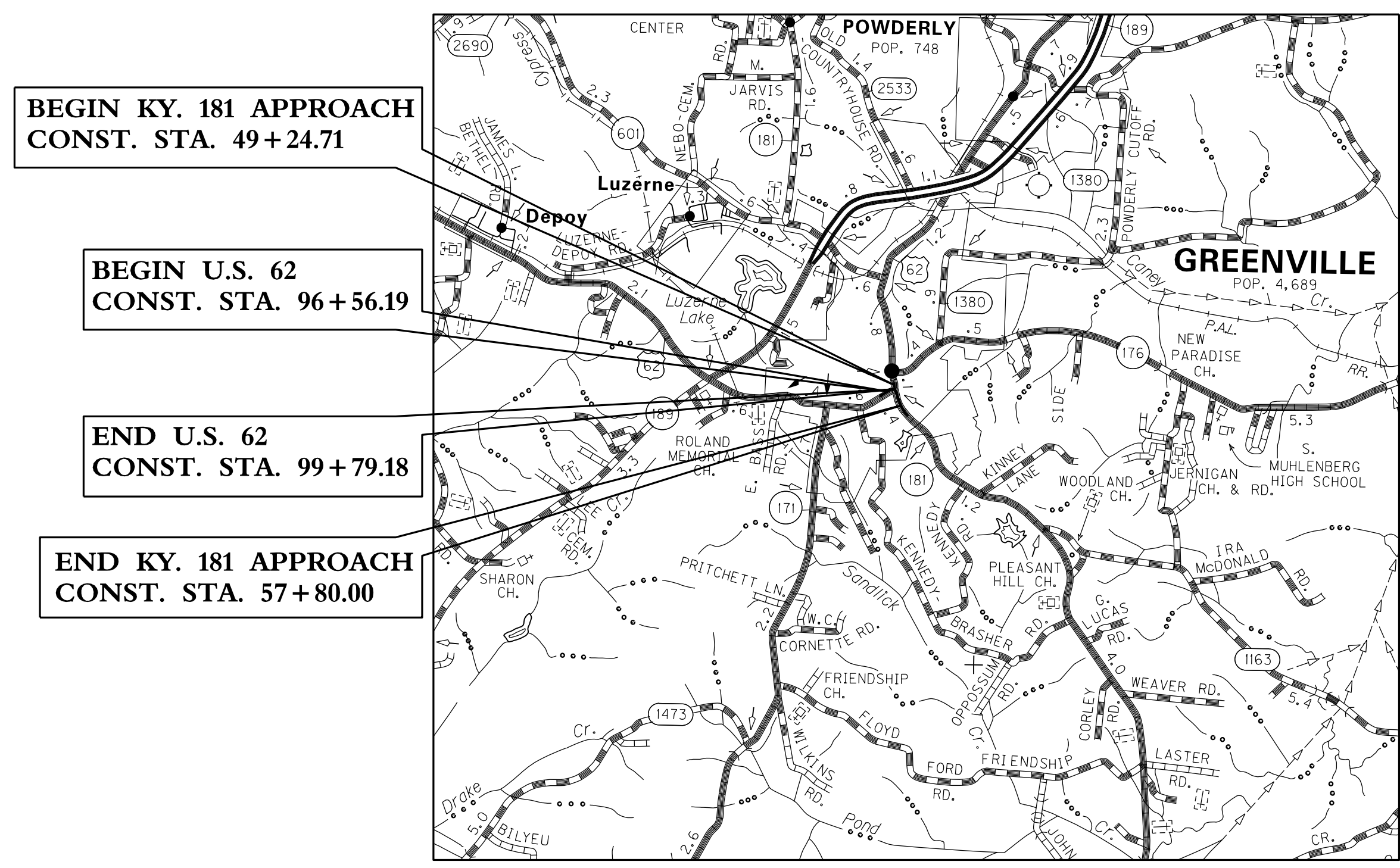

THE CONTROL OF ACCESS ON THIS PROJECT SHALL BE BY PERMIT

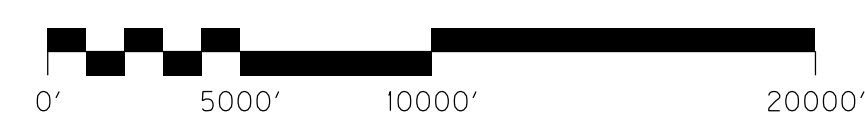

### LAYOUT MAP

### DESIGN CRITERIA

CLASS OF HIGHWAY	URBAN COLLECTOR
TYPE OF TERRAIN	ROLLING
DESIGN SPEED	35 M.P.H.
REQUIRED NPSD	250'
REQUIRED PSD	
LEVEL OF SERVICE	
ADT PRESENT ( 2005 )	8200
ADT FUTURE ( 2026 )	11,100
DHV (2026)	1070
D %	
T %	12.6%

### GEOGRAPHIC COORDINATES

LATITUDE 37 DEGREES 11 MINUTES 56 SECONDS NORTH  
LONGITUDE 87 DEGREES 10 MINUTES 42 SECONDS WEST

### DESIGNED

% RESTRICTED SD	
LEVEL OF SERVICE	
MAX. DISTANCE W/O PASSING	

U.S. 62		KY 181					
LENGTH	ADD DEDUCTED	LENGTH	ADD DEDUCTED	LENGTH	ADD DEDUCTED	LENGTH	ADD DEDUCTED
322.99	FOR EQUALITIES	855.29	FOR EQUALITIES		FOR EQUALITIES		FOR EQUALITIES
0.061	NOT INCLUDED	0.162	NOT INCLUDED		NOT INCLUDED		NOT INCLUDED
RAILROAD CROSSINGS NO.		RAILROAD CROSSINGS NO.		RAILROAD CROSSINGS NO.		RAILROAD CROSSINGS NO.	
BRIDGES		BRIDGES		BRIDGES		BRIDGES	

**Commonwealth of Kentucky  
DEPARTMENT OF HIGHWAYS  
COUNTY OF  
MUHLENBERG**

ITEM NO. 2-138.10

PROJECT NUMBER: JL03 089 0062 010-011

LETTING DATE: \_\_\_\_\_

RECOMMENDED BY: Charolette Cotton DATE: 3-26-12

PLAN APPROVED BY: [Signature] DATE: 2-26-12

Plans Prepared By :  
MUNICIPAL ENGINEERING COMPANY

*Eric Brad Gregory*

ERIC BRAD GREGORY, P.E.  
KY. NO. 22833

FILE NAME: F:\WORK\0501\0501A\DON\0501ACOVER.DGN  
 USER: Jim  
 DATE PLOTTED: September 12, 2011  
 E-SHEET NAME:  
 MicroStation v8.11.7.180

## GENERAL SUMMARY

COUNTY OF	ITEM NO.	SHEET NO.
MUHLENBERG	2-138.10	R2B

ITEM	DESCRIPTION	UNIT	U. S. 62	K Y. 181													PROJECT TOTALS
1792	ADJUST SAN. SEWER MANHOLE	EACH		2													2
1810	STANDARD CURB AND GUTTER	LIN. FT.	546	641													1187
1811	STANDARD CURB AND GUTTER - MODIFIED	LIN. FT.		35													35
1875	STANDARD HEADER CURB ③	LIN. FT.	201	3													204
1946	MOUNTABLE MEDIAN TYPE 2A	SO. YD.	4														4
2091	REMOVE PAVEMENT	SO. YD.		59													59
2203	STRUCTURAL EXCAVATION - UNCLASSIFIED	CU. YD.	122	51													173
2204	SPECIAL EXCAVATION ⑤	CU. YD.	170	249													419
2230	EMBANKMENT IN PLACE	CU. YD.	252	2322												⑥	3371
2242	WATER ④	M. GAL.	0.1														0.1
2429	RIGHT OF WAY MONUMENT TYPE 1	EACH	11	11													22
2430	RIGHT OF WAY MONUMENT TYPE 1A	EACH	6	8													14
2432	WITNESS POST	EACH	3														3
2484	CHANNEL LINING - CLASS III	TON		584													584
2545	CLEARING AND GRUBBING ①	LP. SUM															1
2551	CLASS 'A' CONCRETE FOR STEPS	CU. YD.		1.64													1.64
2555	CLASS 'B' CONCRETE (FOR RETAINING WALL)	CU. YD.	118	37													155
2562	SIGNS	SO. FT.	141	61													202
2569	DEMOBILIZATION	LP. SUM															1
2585	EDGE KEY	LIN. FT.	24	54													78
2599	FABRIC - GEOTEXTILE TYPE IV ⑤	SO. YD.	1129	1637													2766
2600	GEOTEXTILE FABRIC TY IV FOR PIPE	SO. YD.	1417	2360													3777
2611	HANDRAIL TYPE A-1	LIN. FT.	145	64													209
2619	HANDRAIL TYPE A	LIN. FT.		14													14
2650	MAINTAIN AND CONTROL TRAFFIC	LP. SUM															1
2701	TEMPORARY SILT FENCE	LIN. FT.	345	855													1200
2709	CLEAN TEMPORARY SILT FENCE	LIN. FT.	345	855													1200
2703	SILT TRAP TYPE A ②	EACH	1	2													3
2706	CLEAN SILT TRAP TYPE A ②	EACH	3	6													9
2704	SILT TRAP TYPE B ②	EACH	1	2													3
2707	CLEAN SILT TRAP TYPE B ②	EACH	3	6													9
2705	SILT TRAP TYPE C ②	EACH	1	2													3
2708	CLEAN SILT TRAP TYPE C ②	EACH	3	6													9
2720	SIDEWALK - 4" CONCRETE	SO. YD.	404	140													544
2726	STAKING	LP. SUM															1
5950	EROSION CONTROL BLANKET	SO. YDS.	25														25
5952	TEMPORARY MULCH	SO. YD.	3630	10309													13939
5953	TEMPORARY SEEDING AND PROTECTION	SO. YD.	3630	10309													13939
5966	TOP DRESSING FERTILIZER	TON	0.02	0.23													0.25
5985	SEEDING AND PROTECTION	SO. YD.		3935													3935
5990	SODDING	SO. YD.	342	479													821
6510	PAVEMENT STRIPING - TEMPORARY PAINT 4"	LIN. FT.	2836	6254													9090
6514	PAVEMENT STRIPING - PERMANENT PAINT 4"	LIN. FT.	1525	2610													4135
6530	PAVEMENT STRIPING - REMOVAL - 4"	LIN. FT.		285													285
6566	PAVEMENT MARKING - THERMO X-WALK 12"	LIN. FT.	136	104													240
6568	PAVEMENT MARKING - THERMO STOP BAR 24"	LIN. FT.	27	49													76
6574	PAVEMENT MARKING - THERMO CURVE ARROW	EACH	2	4													6
6575	PAVEMENT MARKING - THERMO COMBO ARROW	EACH		2													2
2159	TEMPORARY DITCH	LIN. FT.	345	855													1200
21289ED	LONGITUDINAL EDGE KEY	LIN. FT.	495	930													1425
23185EC	BRICK PAVERS FOR SIDEWALK	SO. YD.	45	15													60
23158ES505	DETECTABLE WARNINGS	SO. FT.	66	60													126
24416EC	REMOVE AND RESET LANDSCAPE WALL ⑦	LP. SUM															1
23379EC	STAMPED CONCRETE ⑧	SO. YD.	24														24

**NOTES:**

- ① 1.75 ACRES  
THE CLEARING OF TREES IN UNDISTURBED FORESTED AREAS SHALL BE KEPT TO A MINIMUM AND RESTRICTED TO THE CONSTRUCTION LIMITS.
- ② THE CONTRACTOR SHALL BE REQUIRED TO CLEAN OUT (REMOVE SEDIMENT FROM) SILT TRAPS AND SEDIMENTATION BASINS WHENEVER THEY BECOME ONE-HALF FULL AND PROPERLY DISPOSE OF THE MATERIAL AT SITES APPROVED BY THE ENGINEER.
- ③ ESTIMATED QTY. - AS DIRECTED BY THE ENGINEER
- ④ FOR DUST CONTROL
- ⑤ SEE TYPICAL SECTIONS FOR LOCATION USE AS DIRECTED BY THE ENGINEER
- ⑥ INCLUDES 764 CU. YDS. EMB. BENCH & 33 CU. YDS. REFILL
- ⑦ THE CONTRACTOR SHALL BE RESPONSIBLE FOR REMOVING, STORING AND RESETTING THE EXISTING LANDSCAPE WALL AS DIRECTED BY THE ENGINEER.
- ⑧ THIS BID ITEM INCLUDES THE REMOVAL OF EXISTING CROSSWALK AND RECONSTRUCTION OF CROSSWALK PER DETAIL ON R20A, AND AS DIRECTED BY THE ENGINEER.

- PROJECT EARTHWORK TOTALS -

	1031	COM.																	
	92	DITCH LEFT																	
	265	DITCH RIGHT																	
	173	STRUCTURE EXC. (RETAINING WALLS)																	
	764	EMB. BENCH																	
	<hr/>																		
	2,325	EXC.																	
	<hr/>																		
	2,574	EMB.																	
	764	EMB. BENCH																	
	33	REFILL																	
	<hr/>																		
	3,371	EMB.																	

FILE NAME: G:\PWORK\CHARLOTTE\_COTTON\_00338664\_R0020BSU.DGN

USER: Charlotte.Cotton  
DATE PLOTTED: May 14, 2012

E-SHEET NAME:

MicroStation v8.11.7.180

# GENERAL SUMMARY

COUNTY OF	ITEM NO.	SHEET NO.
MUHLENBERG	2-138.10	R2B

△ REVISED 5-14-12

**NOTES:**

- ① 1.75 ACRES  
THE CLEARING OF TREES IN UNDISTURBED FORESTED AREAS SHALL BE KEPT TO A MINIMUM AND RESTRICTED TO THE CONSTRUCTION LIMITS.
- ② THE CONTRACTOR SHALL BE REQUIRED TO CLEAN OUT (REMOVE SEDIMENT FROM) SILT TRAPS AND SEDIMENTATION BASINS WHENEVER THEY BECOME ONE-HALF FULL AND PROPERLY DISPOSE OF THE MATERIAL AT SITES APPROVED BY THE ENGINEER.
- ③ ESTIMATED QTY. - AS DIRECTED BY THE ENGINEER
- ④ FOR DUST CONTROL
- ⑤ SEE TYPICAL SECTIONS FOR LOCATION USE AS DIRECTED BY THE ENGINEER
- ⑥ INCLUDES 764 CU. YDS. EMB. BENCH & 33 CU. YDS. REFILL
- ⑦ THE CONTRACTOR SHALL BE RESPONSIBLE FOR REMOVING, STORING AND RESETTING THE EXISTING LANDSCAPE WALL AS DIRECTED BY THE ENGINEER.
- ⑧ THIS BID ITEM INCLUDES THE REMOVAL OF EXISTING CROSSWALK AND RECONSTRUCTION OF CROSSWALK PER DETAIL ON R20A, AND AS DIRECTED BY THE ENGINEER.

- PROJECT EARTHWORK TOTALS -

1031	COM.		
92	DITCH LEFT		
265	DITCH RIGHT		
173	STRUCTURE EXC. (RETAINING WALLS)		
764	EMB. BENCH		
<hr/>			
2,325	EXC.		
<hr/>			
2,574	EMB.		
764	EMB. BENCH		
33	REFILL		
<hr/>			
3,371	EMB.		

ITEM	DESCRIPTION	UNIT	U. S. 62	K Y. 181													PROJECT TOTALS
1792	ADJUST SAN. SEWER MANHOLE	EACH		2													2
1810	STANDARD CURB AND GUTTER	LIN. FT.	546	641													1187
1811	STANDARD CURB AND GUTTER - MODIFIED	LIN. FT.		35													35
1875	STANDARD HEADER CURB ③	LIN. FT.	201	3													204
1946	MOUNTABLE MEDIAN TYPE 2A	SO. YD.	4														4
2091	REMOVE PAVEMENT	SO. YD.		59													59
2203	STRUCTURAL EXCAVATION - UNCLASSIFIED	CU. YD.	122	51													173
2204	SPECIAL EXCAVATION ⑤	CU. YD.	170	249													419
2230	EMBANKMENT IN PLACE	CU. YD.	252	2322												⑥	3371
2242	WATER ④	M. GAL.	0.1														0.1
2429	RIGHT OF WAY MONUMENT TYPE 1	EACH	11	11													22
2430	RIGHT OF WAY MONUMENT TYPE 1A	EACH	6	8													14
2432	WITNESS POST	EACH	3														3
2484	CHANNEL LINING - CLASS III	TON		584													584
2545	CLEARING AND GRUBBING ①	LP. SUM															1
2551	CLASS 'A' CONCRETE FOR STEPS	CU. YD.		1.64													1.64
2555	CLASS 'B' CONCRETE (FOR RETAINING WALL)	CU. YD.	118	37													155
2562	SIGNS	SO. FT.	141	61													202
2569	DEMOBILIZATION	LP. SUM															1
2585	EDGE KEY	LIN. FT.	24	54													78
2599	FABRIC - GEOTEXTILE TYPE IV ⑤	SO. YD.	1129	1637													2766
2600	GEOTEXTILE FABRIC TY IV FOR PIPE	SO. YD.	1417	2360													3777
2611	HANDRAIL TYPE A-1	LIN. FT.	145	64													209
2619	HANDRAIL TYPE A	LIN. FT.		14													14
2650	MAINTAIN AND CONTROL TRAFFIC	LP. SUM															1
2701	TEMPORARY SILT FENCE	LIN. FT.	345	855													1200
2709	CLEAN TEMPORARY SILT FENCE	LIN. FT.	345	855													1200
2703	SILT TRAP TYPE A ②	EACH	1	2													3
2706	CLEAN SILT TRAP TYPE A ②	EACH	3	6													9
2704	SILT TRAP TYPE B ②	EACH	1	2													3
2707	CLEAN SILT TRAP TYPE B ②	EACH	3	6													9
2705	SILT TRAP TYPE C ②	EACH	1	2													3
2708	CLEAN SILT TRAP TYPE C ②	EACH	3	6													9
2720	SIDEWALK - 4" CONCRETE	SO. YD.	404	140													544
2726	STAKING	LP. SUM															1
5950	EROSION CONTROL BLANKET	SO. YDS.	25														25
5952	TEMPORARY MULCH	SO. YD.	3630	10309													13939
5953	TEMPORARY SEEDING AND PROTECTION	SO. YD.	3630	10309													13939
5966	TOP DRESSING FERTILIZER	TON	0.02	0.23													0.25
5985	SEEDING AND PROTECTION	SO. YD.		3935													3935
5990	SODDING	SO. YD.	342	479													821
6510	PAVEMENT STRIPING - TEMPORARY PAINT 4"	LIN. FT.	2836	6254													9090
6514	PAVEMENT STRIPING - PERMANENT PAINT 4"	LIN. FT.	1525	2610													4135
6530	PAVEMENT STRIPING - REMOVAL - 4"	LIN. FT.		285													285
6566	PAVEMENT MARKING - THERMO X-WALK 12"	LIN. FT.	136	104													240
6568	PAVEMENT MARKING - THERMO STOP BAR 24"	LIN. FT.	27	49													76
6574	PAVEMENT MARKING - THERMO CURVE ARROW	EACH	2	4													6
6575	PAVEMENT MARKING - THERMO COMBO ARROW	EACH		2													2
2159	TEMPORARY DITCH	LIN. FT.	345	855													1200
21289ED	LONGITUDINAL EDGE KEY	LIN. FT.	495	930													1425
23185EC	BRICK PAVERS FOR SIDEWALK	SO. YD.	45	15													60
23158ES505	DETECTABLE WARNINGS	SO. FT.	66	60													126
24416EC	REMOVE AND RESET LANDSCAPE WALL ⑦	LP. SUM															1
23379EC	STAMPED CONCRETE ⑧	SO. YD.	24														24

FILE NAME: G:\PWORK\CHARLOTTE\_COTTON\_00338664\_R0020BSU.DGN  
 USER: Charlotte.Cotton  
 DATE PLOTTED: May 14, 2012  
 E-SHEET NAME:  
 MicroStation v8.11.7.180

△ REVISED 5-14-12

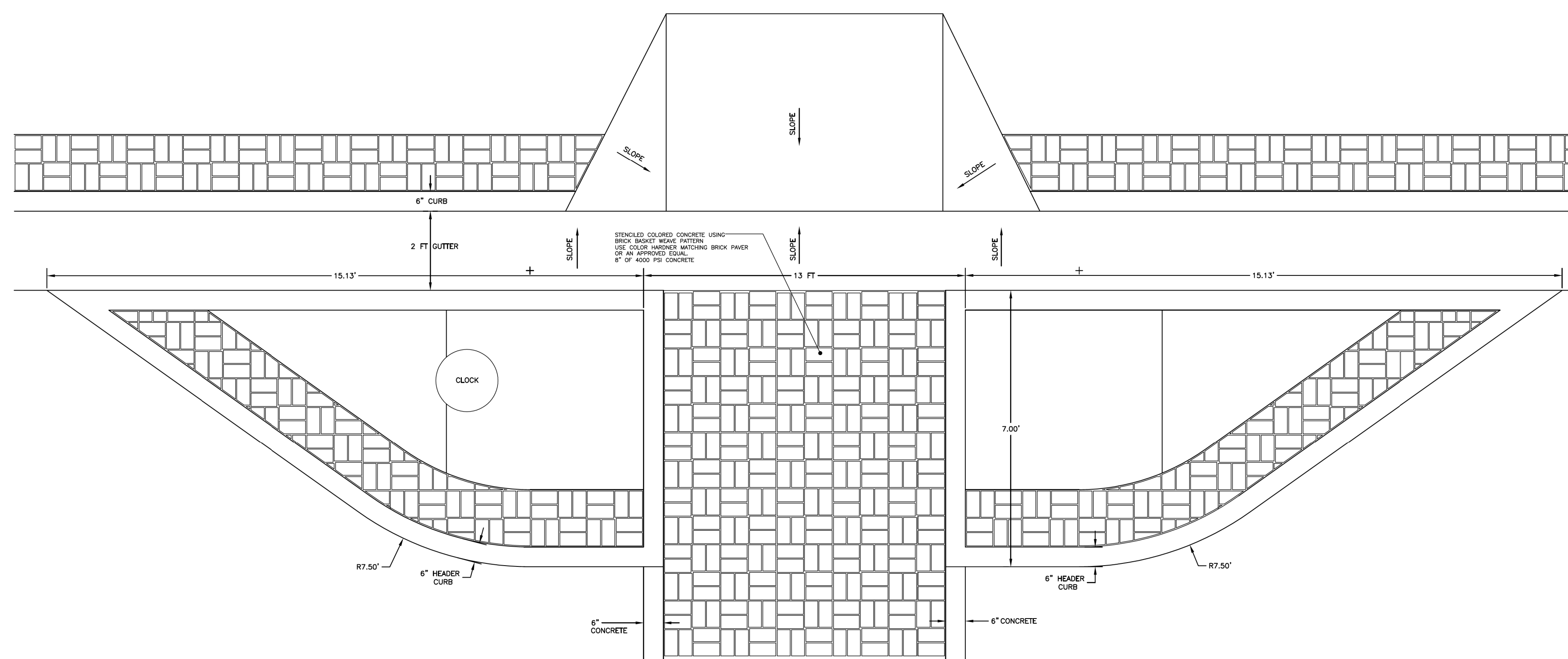

ENLARGEMENT  
 STENCILED COLORED CONCRETE CROSSWALK PATTERN DETAIL  
 N.T.S. D  
1.06

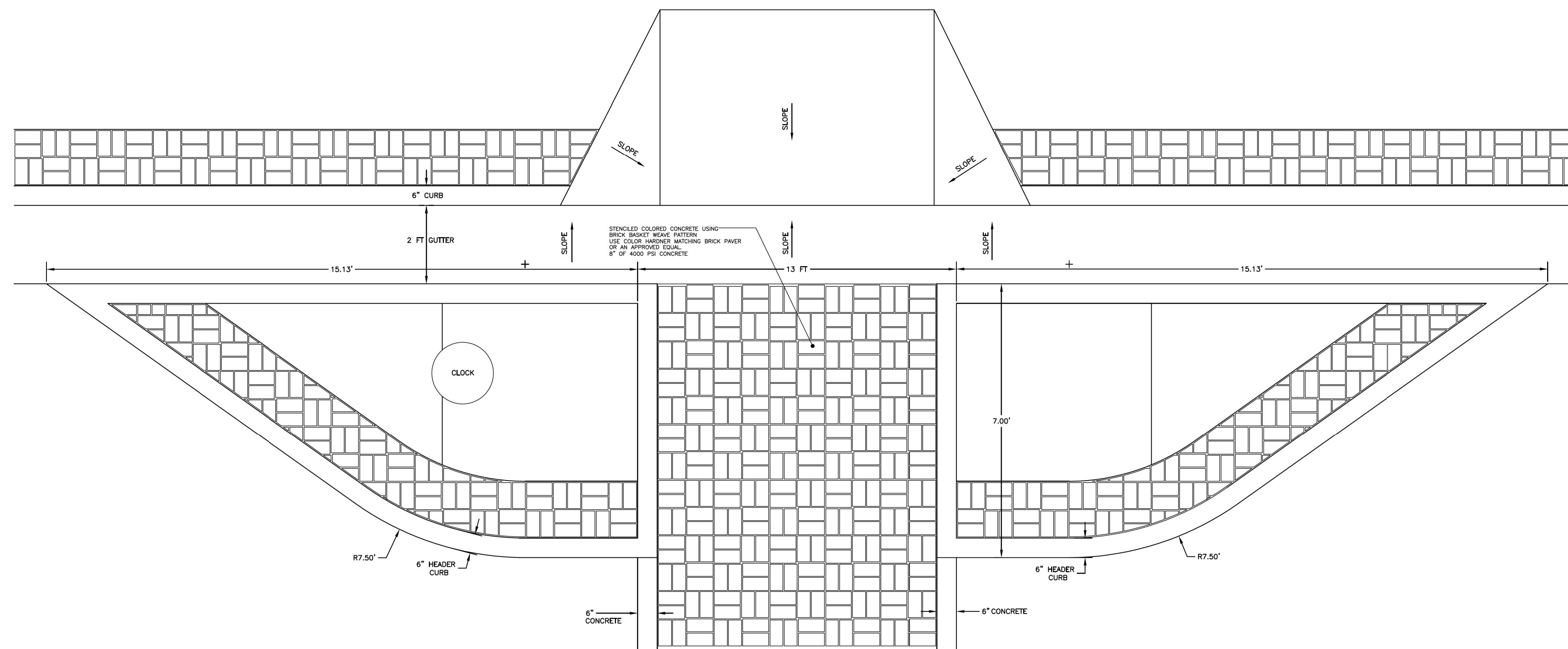

ENLARGEMENT  
 STENCILED COLORED CONCRETE CROSSWALK PATTERN DETAIL  
 N.T.S. D  
1.06



**CALL NO. 402**

**CONTRACT ID. 121321**

**MUHLENBERG COUNTY**

**FED/STATE PROJECT NUMBER 089GR12D004-JL03**

**DESCRIPTION INTERSECTIONS OF US 62-KY 181 AND US 62-KY 171**

**WORK TYPE GRADE & DRAIN WITH ASPHALT SURFACE**

**PRIMARY COMPLETION DATE 12/15/2012**

**LETTING DATE: May 18, 2012**

Sealed Bids will be received electronically through the Bid Express bidding service until 10:00 AM EASTERN DAYLIGHT TIME May 18, 2012. Bids will be publicly announced at 10:00 AM EASTERN DAYLIGHT TIME.

**ROAD PLANS**

**REQUIRED BID PROPOSAL GUARANTY:** Not less than 5% of the total bid.



MATERIAL SUMMARY

CONTRACT ID: 121321

JL03 089 0062 009-010

PES NO: DE089006212R1

INTERSECTION OF US 62 AND KY 171 RECONSTRUCT THE US 62-KY 171 INTERSECTION BY ADDING  
TURN LANES TO IMPROVE EFFICIENCY AND SAFETY

LINE NO	BID CODE	DESCRIPTION	QUANTITY	UNIT
0010	00003	CRUSHED STONE BASE	2,423.00	TON
0020	00020	TRAFFIC BOUND BASE	208.00	TON
0030	00078	CRUSHED AGGREGATE SIZE NO 2	2,243.00	TON
0040	00190	LEVELING & WEDGING PG64-22	1,077.00	TON
0050	00214	CL3 ASPH BASE 1.00D PG64-22	554.00	TON
0060	00216	CL3 ASPH BASE 1.00D PG76-22	361.00	TON
0070	00326	CL3 ASPH SURF 0.50B PG76-22	744.00	TON
0080	00521	STORM SEWER PIPE-15 IN	2,021.00	LF
0090	00522	STORM SEWER PIPE-18 IN	945.00	LF
0100	00524	STORM SEWER PIPE-24 IN	107.00	LF
0110	00980	SLOTTED DRAIN PIPE-12 IN	120.00	LF
0120	01432	SLOPED BOX OUTLET TYPE 1-15 IN	2.00	EACH
0130	01433	SLOPED BOX OUTLET TYPE 1-18 IN	1.00	EACH
0140	01434	SLOPED BOX OUTLET TYPE 1-24 IN	1.00	EACH
0150	01544	DROP BOX INLET TYPE 11	5.00	EACH
0160	01559	DROP BOX INLET TYPE 13G	15.00	EACH
0170	01568	DROP BOX INLET TYPE 13S	2.00	EACH
0180	01577	DROP BOX INLET TYPE 14	4.00	EACH
0190	01581	DROP BOX INLET TYPE 16G	1.00	EACH
0200	01587	DROP BOX INLET TYPE 16S	2.00	EACH
0210	01641	JUNCTION BOX-15 IN	1.00	EACH
0220	01756	MANHOLE TYPE A	3.00	EACH
0230	01810	STANDARD CURB AND GUTTER	3,273.00	LF
0240	02101	CEM CONC ENT PAVEMENT-8 IN	495.00	SQYD
0250	02159	TEMP DITCH	2,218.00	LF
0260	02204	SPECIAL EXCAVATION	1,245.00	CUYD
0270	02230	EMBANKMENT IN PLACE	3,181.00	CUYD
0280	02242	WATER	0.16	MGAL
0290	02429	RIGHT-OF-WAY MONUMENT TYPE 1	27.00	EACH
0300	02430	RIGHT-OF-WAY MONUMENT TYPE 1A	4.00	EACH
0310	02432	WITNESS POST	3.00	EACH
0320	02483	CHANNEL LINING CLASS II	29.00	TON
0330	02545	CLEARING AND GRUBBING 1.72 ACRES	1.00	LS
0340	02551	CONCRETE-CLASS A FOR STEPS	1.08	CUYD
0350	02562	SIGNS	222.00	SQFT
0360	02585	EDGE KEY	100.00	LF
0370	02599	FABRIC-GEOTEXTILE TYPE IV	7,048.00	SQYD
0380	02600	FABRIC GEOTEXTILE TY IV FOR PIPE	10,526.00	SQYD
0390	02619	HANDRAIL-TYPE A	16.00	LF
0400	02650	MAINTAIN & CONTROL TRAFFIC MP 9-10	1.00	LS
0410	02701	TEMP SILT FENCE	2,032.00	LF
0420	02703	SILT TRAP TYPE A	5.00	EACH
0430	02704	SILT TRAP TYPE B	5.00	EACH
0440	02705	SILT TRAP TYPE C	5.00	EACH
0450	02706	CLEAN SILT TRAP TYPE A	15.00	EACH
0460	02707	CLEAN SILT TRAP TYPE B	15.00	EACH
0470	02708	CLEAN SILT TRAP TYPE C	15.00	EACH
0480	02709	CLEAN TEMP SILT FENCE	2,032.00	LF
0490	02720	SIDEWALK-4 IN CONCRETE	1,249.00	SQYD
0500	02726	STAKING	1.00	LS

MATERIAL SUMMARY

CONTRACT ID: 121321

QTY	UNIT	DESCRIPTION	PRICE
		MP 9-10	
0510	05950	EROSION CONTROL BLANKET	25.00 SQYD
0520	05952	TEMP MULCH	23,309.00 SQYD
0530	05953	TEMP SEEDING AND PROTECTION	23,309.00 SQYD
0540	05966	TOPDRESSING FERTILIZER	0.20 TON
0550	05985	SEEDING AND PROTECTION	3,000.00 SQYD
0560	05990	SODDING	5,643.00 SQYD
0570	06510	PAVE STRIPING-TEMP PAINT-4 IN	4,064.00 LF
0580	06514	PAVE STRIPING-PERM PAINT-4 IN	4,687.00 LF
0590	06574	PAVE MARKING-THERMO CURV ARROW	12.00 EACH
0600	08100	CONCRETE-CLASS A	1.35 CUYD
0610	08150	STEEL REINFORCEMENT	8.00 LB
0620	21289ED	LONGITUDINAL EDGE KEY	3,350.00 LF
0630	23131ER701	PIPELINE VIDEO INSPECTION	1,597.00 LF
0640	23158ES505	DETECTABLE WARNINGS	210.00 SQFT
0650	02569	DEMobilIZATION	1.00 LS

JL03 089 0062 010-011

PES NO: DE089006212R2

INTERSECTION OF US 62 AND KY 181 RECONSTRUCT THE US 62-KY 181 INTERSECTION BY ADDING TURN LANES TO IMPROVE EFFICIENCY AND SAFETY

LINE NO	BID CODE	DESCRIPTION	QUANTITY	UNIT
0010	00003	CRUSHED STONE BASE	1,106.00	TON
0020	00020	TRAFFIC BOUND BASE	120.00	TON
0030	00078	CRUSHED AGGREGATE SIZE NO 2	696.00	TON
0040	00190	LEVELING & WEDGING PG64-22	434.00	TON
0050	00214	CL3 ASPH BASE 1.00D PG64-22	252.00	TON
0060	00216	CL3 ASPH BASE 1.00D PG76-22	138.00	TON
0070	00326	CL3 ASPH SURF 0.50B PG76-22	382.00	TON
0080	00520	STORM SEWER PIPE-12 IN	35.00	LF
0090	00522	STORM SEWER PIPE-18 IN	1,040.00	LF
0100	01433	SLOPED BOX OUTLET TYPE 1-18 IN	2.00	EACH
0110	01547	DROP BOX INLET TYPE 12	30.00	LF
0120	01559	DROP BOX INLET TYPE 13G	9.00	EACH
0130	01568	DROP BOX INLET TYPE 13S	2.00	EACH
0140	01577	DROP BOX INLET TYPE 14	1.00	EACH
0150	01756	MANHOLE TYPE A	2.00	EACH
0160	01792	ADJUST MANHOLE	2.00	EACH
0170	01810	STANDARD CURB AND GUTTER	1,187.00	LF
0180	01811	STANDARD CURB AND GUTTER MOD	35.00	LF
0190	01875	STANDARD HEADER CURB	204.00	LF
0200	01946	MOUNTABLE MEDIAN TYPE 2A	4.00	SQYD
0210	02091	REMOVE PAVEMENT	59.00	SQYD
0220	02101	CEM CONC ENT PAVEMENT-8 IN	181.00	SQYD
0230	02159	TEMP DITCH	1,200.00	LF
0240	02203	STRUCTURE EXCAV-UNCLASSIFIED	173.00	CUYD
0250	02204	SPECIAL EXCAVATION	419.00	CUYD
0260	02230	EMBANKMENT IN PLACE	3,371.00	CUYD
0270	02242	WATER	0.10	MGAL
0280	02429	RIGHT-OF-WAY MONUMENT TYPE 1	22.00	EACH
0290	02430	RIGHT-OF-WAY MONUMENT TYPE 1A	14.00	EACH
0300	02432	WITNESS POST	3.00	EACH
0310	02484	CHANNEL LINING CLASS III	584.00	TON
0320	02545	CLEARING AND GRUBBING 1.75 ACRES	1.00	LS
0330	02551	CONCRETE-CLASS A FOR STEPS	1.64	CUYD
0340	02555	CONCRETE-CLASS B	155.00	CUYD
0350	02562	SIGNS	202.00	SQFT
0360	02585	EDGE KEY	78.00	LF
0370	02599	FABRIC-GEOTEXTILE TYPE IV	2,766.00	SQYD
0380	02600	FABRIC GEOTEXTILE TY IV FOR PIPE	3,777.00	SQYD
0390	02611	HANDRAIL-TYPE A-1	209.00	LF
0400	02619	HANDRAIL-TYPE A	14.00	LF
0410	02650	MAINTAIN & CONTROL TRAFFIC MP 10-11	1.00	LS
0420	02701	TEMP SILT FENCE	1,200.00	LF
0430	02703	SILT TRAP TYPE A	3.00	EACH
0440	02704	SILT TRAP TYPE B	3.00	EACH
0450	02705	SILT TRAP TYPE C	3.00	EACH

0460	02706	CLEAN SILT TRAP TYPE A	9.00	EACH
0470	02707	CLEAN SILT TRAP TYPE B	9.00	EACH
0480	02708	CLEAN SILT TRAP TYPE C	9.00	EACH
0490	02709	CLEAN TEMP SILT FENCE	1,200.00	LF
0500	02720	SIDEWALK-4 IN CONCRETE	544.00	SQYD
0510	02726	STAKING	1.00	LS
		MP 10-11		
0520	05950	EROSION CONTROL BLANKET	25.00	SQYD
0530	05952	TEMP MULCH	13,939.00	SQYD
0540	05953	TEMP SEEDING AND PROTECTION	13,939.00	SQYD
0550	05966	TOPDRESSING FERTILIZER	0.25	TON
0560	05985	SEEDING AND PROTECTION	3,935.00	SQYD
0570	05990	SODDING	821.00	SQYD
0580	06510	PAVE STRIPING-TEMP PAINT-4 IN	9,090.00	LF
0590	06514	PAVE STRIPING-PERM PAINT-4 IN	4,135.00	LF
0600	06530	PAVE STRIPING REMOVAL-4 IN	285.00	LF
0610	06566	PAVE MARKING-THERMO X-WALK-12 IN	240.00	LF
0620	06568	PAVE MARKING-THERMO STOP BAR-24IN	76.00	LF
0630	06574	PAVE MARKING-THERMO CURV ARROW	6.00	EACH
0640	06575	PAVE MARKING-THERMO COMB ARROW	2.00	EACH
0650	23131ER701	PIPELINE VIDEO INSPECTION	538.00	LF
0660	23158ES505	DETECTABLE WARNINGS	126.00	SQFT
0670	23185EC	BRICK-PAVERS FOR SIDEWALK	60.00	SQYD
1320	23379EC	STAMPED CONCRETE (ADDED: 5-14-12)	24.00	SQYD
0680	24416EC	REMOVE AND RESET LANDSCAPE WALL	1.00	LS
0690	04793	CONDUIT-1 1/4 IN	50.00	LF
0700	04795	CONDUIT-2 IN	286.00	LF
0710	04811	JUNCTION BOX TYPE B	4.00	EACH
0720	04820	TRENCHING AND BACKFILLING	95.00	LF
0730	04830	LOOP WIRE	2,115.00	LF
0740	04844	CABLE-NO. 14/5C	966.00	LF
0750	04850	CABLE-NO. 14/1 PAIR	1,010.00	LF
0760	04881	MAST ARM POLE	2.00	EACH
0770	04895	LOOP SAW SLOT AND FILL	796.00	LF
0780	04931	INSTALL CONTROLLER TYPE 170	1.00	EACH
0790	20188NS835	INSTALL LED SIGNAL-3 SECTION	10.00	EACH
0800	21543EN	BORE AND JACK CONDUIT	175.00	LF
0810	21743NN	INSTALL PEDESTRIAN DETECTOR	2.00	EACH
0820	23064NN	INSTALL SIGNAL-PEDESTRIAN COUNTDOWN	4.00	EACH
0830	23157EN	TRAFFIC SIGNAL POLE BASE	7.07	CUYD
0840	23222EC	INSTALL SIGNAL PEDESTAL	2.00	EACH
0850	23982EC	INSTALL ANTENNA	1.00	EACH
0860	24488ED	INSTALL MAST ARM MOUNTED SIGN	1.00	EACH
0870	02569	DEMOBILIZATION	1.00	LS
0880	01065	STEEL ENCASEMENT PIPE-8 IN OPEN CUT	40.00	LF
0890	01071	STEEL ENCASEMENT PIPE-14 IN BORE	93.00	LF
0900	01075	STEEL ENCASEMENT PIPE-18 IN BORE	30.00	LF
0910	01075	STEEL ENCASEMENT PIPE-18 IN OPEN CUT	70.00	LF
0920	03381	PVC PIPE-2 IN	70.00	LF
0930	03383	PVC PIPE-4 IN	60.00	LF
0940	03385	PVC PIPE-6 IN	580.00	LF
0950	03389	PVC PIPE-10 IN	2,900.00	LF
0960	03495	AIR RELEASE VALVE	2.00	EACH
0970	03526	GATE VALVE-6 IN	13.00	EACH
0980	03530	GATE VALVE-10 IN	10.00	EACH
0990	03547	BEND 22.50 DEG 10 IN	3.00	EACH
1000	03555	BEND 45 DEG 10 IN	2.00	EACH
1010	03559	BEND 90 DEG 4 IN	2.00	EACH
1020	03560	BEND 90 DEG 6 IN	2.00	EACH
1030	03561	BEND 90 DEG 10 IN	1.00	EACH
1040	20156EC	FIRE HYDRANT ASSEMBLY	8.00	EACH
1050	20311EC	SERVICE LINE-3/4 IN COPPER	769.00	LF

1060	20953ND	TEE-10 IN X 10 IN	2.00	EACH
1080	20955ND	TEE-10 IN X 6 IN	11.00	EACH
1090	20956ND	REDUCER-10 IN X 8 IN	1.00	EACH
1100	20957ND	REDUCER-10 IN X 6 IN	1.00	EACH
1110	23308EC	WATER METER WITH BOX	28.00	EACH
1120	23741EC	TEE-6 X 6 IN	1.00	EACH
1130	24444ND	TEE 10 IN X 4 IN	2.00	EACH
1140	24445EC	STONE FILL NO. 9	700.00	TON
1150	24446EC	ASPHALT PAVING DRIVEWAYS	150.00	TON
1160	24451EC	CONCRETE WALKS	6.00	CUYD
1170	24452EC	SEEDING	5.00	ACRE
1180	01050	SEWER PIPE-4 IN	200.00	LF
1190	01051	SEWER PIPE-6 IN	630.00	LF
1200	01052	SEWER PIPE-8 IN	1,542.00	LF
1210	01073	STEEL ENCASEMENT PIPE-16 IN OPEN CUT	160.00	LF
1220	02690	SAFELOADING	5.00	CUYD
1230	03479	TIE-IN	3.00	EACH
1240	20425ED	ABANDON MANHOLE	4.00	EACH
1250	23774EC	MANHOLE-6 FT	6.00	EACH
1260	24445EC	STONE FILL NO. 9	350.00	TON
1270	24446EC	ASPHALT PAVING	150.00	TON
1280	24447EC	PVC WYE-8 X 6	20.00	EACH
1290	24448EC	CLEANOUT ASSEMBLY	20.00	EACH
1300	24449EC	MANHOLE-8 FT	4.00	EACH
1310	24450EC	MANHOLE-12 FT	1.00	EACH
1310	24452EC	SEEDING	3.00	ACRE

CONTRACT ID: 121321  
COUNTY: MUHLENBERG  
PROPOSAL: 089GR12D004-JL03

PAGE: 1  
LETTING: 05/18/12  
CALL NO: 402

LINE NO	ITEM	DESCRIPTION	APPROXIMATE QUANTITY	UNIT	UNIT PRICE	AMOUNT
SECTION 0001 ROADWAY						
0010	00003	CRUSHED STONE BASE	3,529.000	TON		
0020	00020	TRAFFIC BOUND BASE	328.000	TON		
0030	00078	CRUSHED AGGREGATE SIZE NO 2	2,939.000	TON		
0040	00190	LEVELING & WEDGING PG64-22	1,511.000	TON		
0050	00214	CL3 ASPH BASE 1.00D PG64-22	806.000	TON		
0060	00216	CL3 ASPH BASE 1.00D PG76-22	499.000	TON		
0070	00326	CL3 ASPH SURF 0.50B PG76-22	1,126.000	TON		
0080	00520	STORM SEWER PIPE-12 IN	35.000	LF		
0090	00521	STORM SEWER PIPE-15 IN	2,021.000	LF		
0100	00522	STORM SEWER PIPE-18 IN	1,985.000	LF		
0110	00524	STORM SEWER PIPE-24 IN	107.000	LF		
0120	00980	SLOTTED DRAIN PIPE-12 IN	120.000	LF		
0130	01432	SLOPED BOX OUTLET TYPE 1-15 IN	2.000	EACH		
0140	01433	SLOPED BOX OUTLET TYPE 1-18 IN	3.000	EACH		
0150	01434	SLOPED BOX OUTLET TYPE 1-24 IN	1.000	EACH		
0160	01544	DROP BOX INLET TYPE 11	5.000	EACH		
0170	01547	DROP BOX INLET TYPE 12	30.000	LF		
0180	01559	DROP BOX INLET TYPE 13G	24.000	EACH		
0190	01568	DROP BOX INLET TYPE 13S	4.000	EACH		
0200	01577	DROP BOX INLET TYPE 14	5.000	EACH		

CONTRACT ID: 121321  
COUNTY: MUHLENBERG  
PROPOSAL: 089GR12D004-JL03

PAGE: 2  
LETTING: 05/18/12  
CALL NO: 402

LINE NO	ITEM	DESCRIPTION	APPROXIMATE QUANTITY	UNIT	UNIT PRICE	AMOUNT
0210	01581	DROP BOX INLET TYPE 16G	1.000	EACH		
0220	01587	DROP BOX INLET TYPE 16S	2.000	EACH		
0230	01641	JUNCTION BOX-15 IN	1.000	EACH		
0240	01756	MANHOLE TYPE A	5.000	EACH		
0250	01792	ADJUST MANHOLE	2.000	EACH		
0260	01810	STANDARD CURB AND GUTTER	4,460.000	LF		
0270	01811	STANDARD CURB AND GUTTER MOD	35.000	LF		
0280	01875	STANDARD HEADER CURB	204.000	LF		
0290	01946	MOUNTABLE MEDIAN TYPE 2A	4.000	SQYD		
0300	02091	REMOVE PAVEMENT	59.000	SQYD		
0310	02101	CEM CONC ENT PAVEMENT-8 IN	676.000	SQYD		
0320	02159	TEMP DITCH	3,418.000	LF		
0330	02203	STRUCTURE EXCAV-UNCLASSIFIED	173.000	CUYD		
0340	02204	SPECIAL EXCAVATION	1,664.000	CUYD		
0350	02230	EMBANKMENT IN PLACE	6,552.000	CUYD		
0360	02242	WATER	0.260	MGAL		
0370	02429	RIGHT-OF-WAY MONUMENT TYPE 1	49.000	EACH		
0380	02430	RIGHT-OF-WAY MONUMENT TYPE 1A	18.000	EACH		
0390	02432	WITNESS POST	6.000	EACH		
0400	02483	CHANNEL LINING CLASS II	29.000	TON		
0410	02484	CHANNEL LINING CLASS III	584.000	TON		

CONTRACT ID: 121321  
COUNTY: MUHLENBERG  
PROPOSAL: 089GR12D004-JL03

PAGE: 3  
LETTING: 05/18/12  
CALL NO: 402

LINE NO	ITEM	DESCRIPTION	APPROXIMATE QUANTITY	UNIT	UNIT PRICE	AMOUNT
0420	02545	CLEARING AND GRUBBING 1.72 ACRES	( 1.00)	LS		
0430	02545	CLEARING AND GRUBBING 1.75 ACRES	( 1.00)	LS		
0440	02551	CONCRETE-CLASS A FOR STEPS	2.720	CUYD		
0450	02555	CONCRETE-CLASS B	155.000	CUYD		
0460	02562	SIGNS	424.000	SQFT		
0470	02585	EDGE KEY	178.000	LF		
0480	02599	FABRIC-GEOTEXTILE TYPE IV	9,814.000	SQYD		
0490	02600	FABRIC GEOTEXTILE TY IV FOR PIPE	14,303.000	SQYD	2.00	28,606.00
0500	02611	HANDRAIL-TYPE A-1	209.000	LF		
0510	02619	HANDRAIL-TYPE A	30.000	LF		
0520	02650	MAINTAIN & CONTROL TRAFFIC MP 10-11	( 1.00)	LS		
0530	02650	MAINTAIN & CONTROL TRAFFIC MP 9-10	( 1.00)	LS		
0540	02701	TEMP SILT FENCE	3,232.000	LF		
0550	02703	SILT TRAP TYPE A	8.000	EACH		
0560	02704	SILT TRAP TYPE B	8.000	EACH		
0570	02705	SILT TRAP TYPE C	8.000	EACH		
0580	02706	CLEAN SILT TRAP TYPE A	24.000	EACH		
0590	02707	CLEAN SILT TRAP TYPE B	24.000	EACH		
0600	02708	CLEAN SILT TRAP TYPE C	24.000	EACH		
0610	02709	CLEAN TEMP SILT FENCE	3,232.000	LF		
0620	02720	SIDEWALK-4 IN CONCRETE	1,793.000	SQYD		

CONTRACT ID: 121321  
COUNTY: MUHLENBERG  
PROPOSAL: 089GR12D004-JL03

PAGE: 4  
LETTING: 05/18/12  
CALL NO: 402

LINE NO	ITEM	DESCRIPTION	APPROXIMATE QUANTITY	UNIT	UNIT PRICE	AMOUNT
0630	02726	STAKING MP 10-11	( 1.00)	LS		
0640	02726	STAKING MP 9-10	( 1.00)	LS		
0650	05950	EROSION CONTROL BLANKET	50.000	SQYD		
0660	05952	TEMP MULCH	37,248.000	SQYD		
0670	05953	TEMP SEEDING AND PROTECTION	37,248.000	SQYD		
0680	05966	TOPDRESSING FERTILIZER	0.450	TON		
0690	05985	SEEDING AND PROTECTION	6,935.000	SQYD		
0700	05990	SODDING	6,464.000	SQYD		
0710	06510	PAVE STRIPING-TEMP PAINT-4 IN	13,154.000	LF		
0720	06514	PAVE STRIPING-PERM PAINT-4 IN	8,822.000	LF		
0730	06530	PAVE STRIPING REMOVAL-4 IN	285.000	LF		
0740	06566	PAVE MARKING-THERMO X-WALK-12 IN	240.000	LF		
0750	06568	PAVE MARKING-THERMO STOP BAR-24IN	76.000	LF		
0760	06574	PAVE MARKING-THERMO CURV ARROW	18.000	EACH		
0770	06575	PAVE MARKING-THERMO COMB ARROW	2.000	EACH		
0780	08100	CONCRETE-CLASS A	1.350	CUYD		
0790	08150	STEEL REINFORCEMENT	8.000	LB		
0800	21289ED	LONGITUDINAL EDGE KEY	3,350.000	LF		
0810	23131ER701	PIPELINE VIDEO INSPECTION	2,135.000	LF		
0820	23158ES505	DETECTABLE WARNINGS	336.000	SQFT		
0830	23185EC	BRICK-PAVERS FOR SIDEWALK	60.000	SQYD		



CONTRACT ID: 121321  
COUNTY: MUHLENBERG  
PROPOSAL: 089GR12D004-JL03

PAGE: 5  
LETTING: 05/18/12  
CALL NO: 402

LINE NO	ITEM	DESCRIPTION	APPROXIMATE QUANTITY	UNIT	UNIT PRICE	AMOUNT
0831	23379EC	STAMPED CONCRETE (ADDED: 5-14-12)	24.000	SQYD		
0840	24416EC	REMOVE AND RESET LANDSCAPE WALL	( 1.00)	LS		
SECTION 0002 SEWER						
0850	01050	SEWER PIPE-4 IN	200.000	LF		
0860	01051	SEWER PIPE-6 IN	630.000	LF		
0870	01052	SEWER PIPE-8 IN	1,542.000	LF		
0880	01073	STEEL ENCASEMENT PIPE-16 IN OPEN CUT	160.000	LF		
0890	02690	SAFELOADING	5.000	CUYD		
0900	03479	TIE-IN	3.000	EACH		
0910	20425ED	ABANDON MANHOLE	4.000	EACH		
0920	23774EC	MANHOLE-6 FT	6.000	EACH		
0930	24445EC	STONE FILL NO. 9	350.000	TON		
0940	24446EC	ASPHALT PAVING	150.000	TON		
0950	24447EC	PVC WYE-8 X 6	20.000	EACH		
0960	24448EC	CLEANOUT ASSEMBLY	20.000	EACH		
0970	24449EC	MANHOLE-8 FT	4.000	EACH		
0980	24450EC	MANHOLE-12 FT	1.000	EACH		
0990	24452EC	SEEDING	3.000	ACRE		
SECTION 0003 SIGNALIZATION						
1000	04793	CONDUIT-1 1/4 IN	50.000	LF		
1010	04795	CONDUIT-2 IN	286.000	LF		

CONTRACT ID: 121321  
COUNTY: MUHLENBERG  
PROPOSAL: 089GR12D004-JL03

PAGE: 6  
LETTING: 05/18/12  
CALL NO: 402

LINE NO	ITEM	DESCRIPTION	APPROXIMATE QUANTITY	UNIT	UNIT PRICE	AMOUNT
1020	04811	JUNCTION BOX TYPE B	4.000	EACH		
1030	04820	TRENCHING AND BACKFILLING	95.000	LF		
1040	04830	LOOP WIRE	2,115.000	LF		
1050	04844	CABLE-NO. 14/5C	966.000	LF		
1060	04850	CABLE-NO. 14/1 PAIR	1,010.000	LF		
1070	04881	MAST ARM POLE	2.000	EACH		
1080	04895	LOOP SAW SLOT AND FILL	796.000	LF		
1090	04931	INSTALL CONTROLLER TYPE 170	1.000	EACH		
1100	20188NS835	INSTALL LED SIGNAL-3 SECTION	10.000	EACH		
1110	21543EN	BORE AND JACK CONDUIT	175.000	LF		
1120	21743NN	INSTALL PEDESTRIAN DETECTOR	2.000	EACH		
1130	23064NN	INSTALL SIGNAL-PEDESTRIAN COUNTDOWN	4.000	EACH		
1140	23157EN	TRAFFIC SIGNAL POLE BASE	7.070	CUYD		
1150	23222EC	INSTALL SIGNAL PEDESTAL	2.000	EACH		
1160	23982EC	INSTALL ANTENNA	1.000	EACH		
1170	24488ED	INSTALL MAST ARM MOUNTED SIGN	1.000	EACH		
SECTION 0004 WATERLINE						
1180	01065	STEEL ENCASEMENT PIPE-8 IN OPEN CUT	40.000	LF		
1190	01071	STEEL ENCASEMENT PIPE-14 IN BORE	93.000	LF		
1200	01075	STEEL ENCASEMENT PIPE-18 IN BORE	30.000	LF		
1210	01075	STEEL ENCASEMENT PIPE-18 IN OPEN CUT	70.000	LF		

CONTRACT ID: 121321  
COUNTY: MUHLENBERG  
PROPOSAL: 089GR12D004-JL03

PAGE: 7  
LETTING: 05/18/12  
CALL NO: 402

LINE NO	ITEM	DESCRIPTION	APPROXIMATE QUANTITY	UNIT	UNIT PRICE	AMOUNT
1220	03381	PVC PIPE-2 IN	70.000	LF		
1230	03383	PVC PIPE-4 IN	60.000	LF		
1240	03385	PVC PIPE-6 IN	580.000	LF		
1250	03389	PVC PIPE-10 IN	2,900.000	LF		
1260	03495	AIR RELEASE VALVE	2.000	EACH		
1270	03526	GATE VALVE-6 IN	13.000	EACH		
1280	03530	GATE VALVE-10 IN	10.000	EACH		
1290	03547	BEND 22.50 DEG 10 IN	3.000	EACH		
1300	03555	BEND 45 DEG 10 IN	2.000	EACH		
1310	03559	BEND 90 DEG 4 IN	2.000	EACH		
1320	03560	BEND 90 DEG 6 IN	2.000	EACH		
1330	03561	BEND 90 DEG 10 IN	1.000	EACH		
1340	20156EC	FIRE HYDRANT ASSEMBLY	8.000	EACH		
1350	20311EC	SERVICE LINE-3/4 IN COPPER	769.000	LF		
1360	20953ND	TEE-10 IN X 10 IN	2.000	EACH		
1370	20955ND	TEE-10 IN X 6 IN	11.000	EACH		
1380	20956ND	REDUCER-10 IN X 8 IN	1.000	EACH		
1390	20957ND	REDUCER-10 IN X 6 IN	1.000	EACH		
1400	23308EC	WATER METER WITH BOX	28.000	EACH		
1410	23741EC	TEE-6 X 6 IN	1.000	EACH		
1420	24444ND	TEE 10 IN X 4 IN	2.000	EACH		

CONTRACT ID: 121321  
COUNTY: MUHLENBERG  
PROPOSAL: 089GR12D004-JL03

PAGE: 8  
LETTING: 05/18/12  
CALL NO: 402

LINE NO	ITEM	DESCRIPTION	APPROXIMATE QUANTITY	UNIT	UNIT PRICE	AMOUNT
1430	24445EC	STONE FILL NO. 9	700.000	TON		
1440	24446EC	ASPHALT PAVING DRIVEWAYS	150.000	TON		
1450	24451EC	CONCRETE WALKS	6.000	CUYD		
1460	24452EC	SEEDING	5.000	ACRE		
SECTION 0005 DEMOBILIZATION						
1470	02569	DEMOBILIZATION (AT LEAST 1.5%)		LUMP		
		TOTAL BID				